

CREEK SIDE RIPARIAN AREA

- Defined discovery trail - crusher fines material
- Bench at creek overlook
- Enhancement of riparian plant materials
- Protection of habitat - interpretive sign and plantings

OBSERVATION OVERLOOK

- Stream meander easily viewed
- Eroded bank stabilized and armored
- Accessible
- "Bird tree" - a scout troop service project? Bird houses for dying cottonwood

ACTIVE PLAY AREA

- Roller hockey court
- 1/2 court basketball near teen area
- 2-6 yr. playground with sandplay, water play, hillside slide, swings and climber
- 6-12 yr. playground with climbing boulders, climber and swings
- Shelter / playground observation area
- Ground maze with center route accessible
- Sledding hill to north and east
- 10+ teen playground with advanced challenges

ENTRY AREA

- Entry pillars
- Pedestrian access via 5' walk
- Small (20 space) asphalt parking lot
- Uni-sex restroom
- Lights to match street lights

OPENURE AREA

- 10-14 yr. soccer field area
- Little league softball area with 10' backstop

WEST PARK AREA

- Connection to future Greenway trail
- Sand volleyball court
- Shelter with great view to Longs Peak
- Shrub hedge to define park boundaries at entry

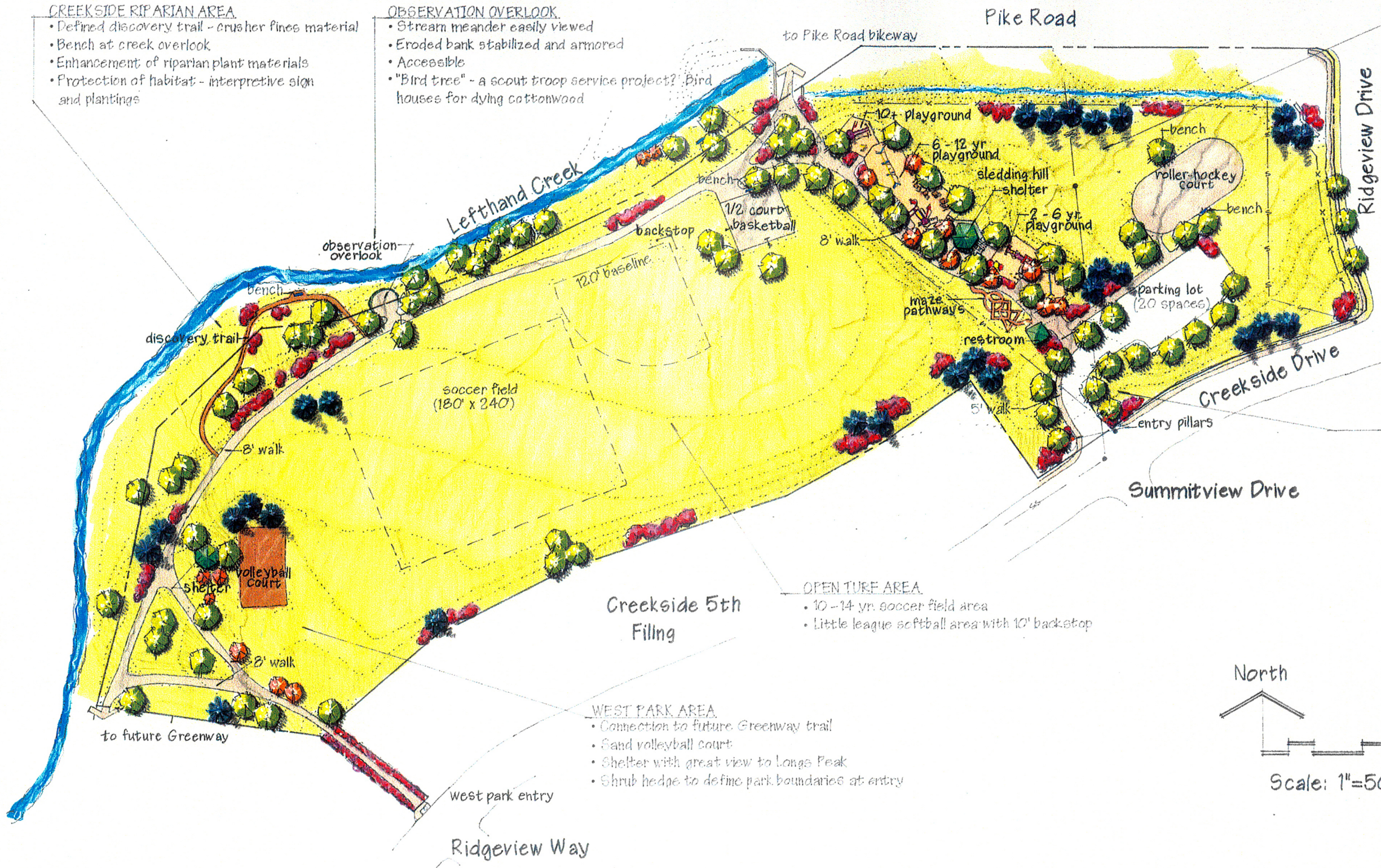

'Lefthand Park'



Date: 9/11/96
P.A.F.